

P.NO.	PART NAME.	MATERIAL
1	BODY	ASTM A-216 Gr. WCB CAST STEEL
2	BONNET	ASTM A - 216 Gr. WCB
3	WEDGE	A 216 WCB with 13% Cr. STEEL FACING
4	GASKET	SS 304 SPIRAL WOUND GASKET WITH GRAPHOL FILLER
5	SEAT	A 105 + 13% Cr. FACING
6	STUD / NUT	ASTM A 193 Gr.B7 / A 194 Gr. 2H
7	BACK SEAT	ASTM A 193 Gr.B7 / A 194 Gr. 2H
8	GLAND	ASTM A 193 Gr.B7 / A 194 Gr. 2H
9	GLAND PACKING	ASTM A 193 Gr.B7 / A 194 Gr. 2H
10	GLAND BOLTING	ASTM A 193 Gr.B7 / A 194 Gr. 2H
11	GLAND FLANGE	ASTM A 193 Gr.B7 / A 194 Gr. 2H
12	STEM	ASTM A 193 Gr.B7 / A 194 Gr. 2H
13	STEM NUT	ASTM A 193 Gr.B7 / A 194 Gr. 2H
14	STEM NUT RETAINER	ASTM A 193 Gr.B7 / A 194 Gr. 2H
15	HAND WHEEL	ASTM A 193 Gr.B7 / A 194 Gr. 2H
16	HANDWHEEL NUT	ASTM A 193 Gr.B7 / A 194 Gr. 2H
17	GREASE NIPPLE	ASTM A 193 Gr.B7 / A 194 Gr. 2H

NOTE :-

MATERIAL GIVEN IN TABLE IS FOR REFERENCE ONLY.
OTHER MATERIALS LIKE CARBON STEEL, LOW CARBON STEEL, ALLOY STEEL, STAINLESS STEEL, DUPLEX STEEL, SUPER DUPLEX STEEL, ALLOY 20, MONEL, INCONEL, HASTELLOY, COPPER ALLOY AVAILABLE AS PER SERVICE REQUIREMENT.

Size(NB)	F to F	OD	FT	1/2 PCD	Hole X ØD	RF	H
25mm	127	110	11	79.4	4 X 15.7	51	195
40mm	165	125	14	98.4	4 X 15.7	73	235
50mm	178	150	15.8	120.7	4 X 19.05	92	320
65mm	190	180	17	139.7	4 X 19.05	105	340
80mm	203	190	19.05	152.4	4 X 19.05	127	410
100mm	229	230	23.8	190.5	8 X 19.05	157	514
125mm	254	255	23.8	215.9	8 X 22.5	185.6	600
150mm	267	280	25.4	241.3	8 X 22.3	216	585
200mm	292	345	28.5	298.5	8 X 22.3	269.7	785
250mm	330	405	30.2	362	12 X 25.4	323.8	945

ENGINEERING DATA	
DESIGN CODE	API 600 / ASME B16.34
FACE TO FACE	ASME B 16-10
END CONNECTION	ASME B 16.5 RF TO 125-250 AARH
INSPECTION & TESTING	API 598

HYDRO TEST: 150#			
BODY	SEAT	BACK SEAT	AIR TEST SEAT
32KG/CM ²	22KG/CM ²	22KG/CM ²	07KG/CM ²

DRN : B.M.P	
CHK : V.G.P	
APRD : S.K.P	
DATE: 01.04.19	GATE VALVE FLANGED ENDS, 150#.
SCALE: NTS	

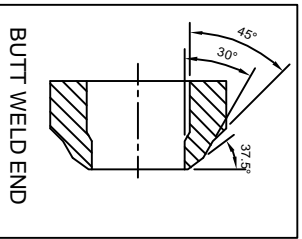
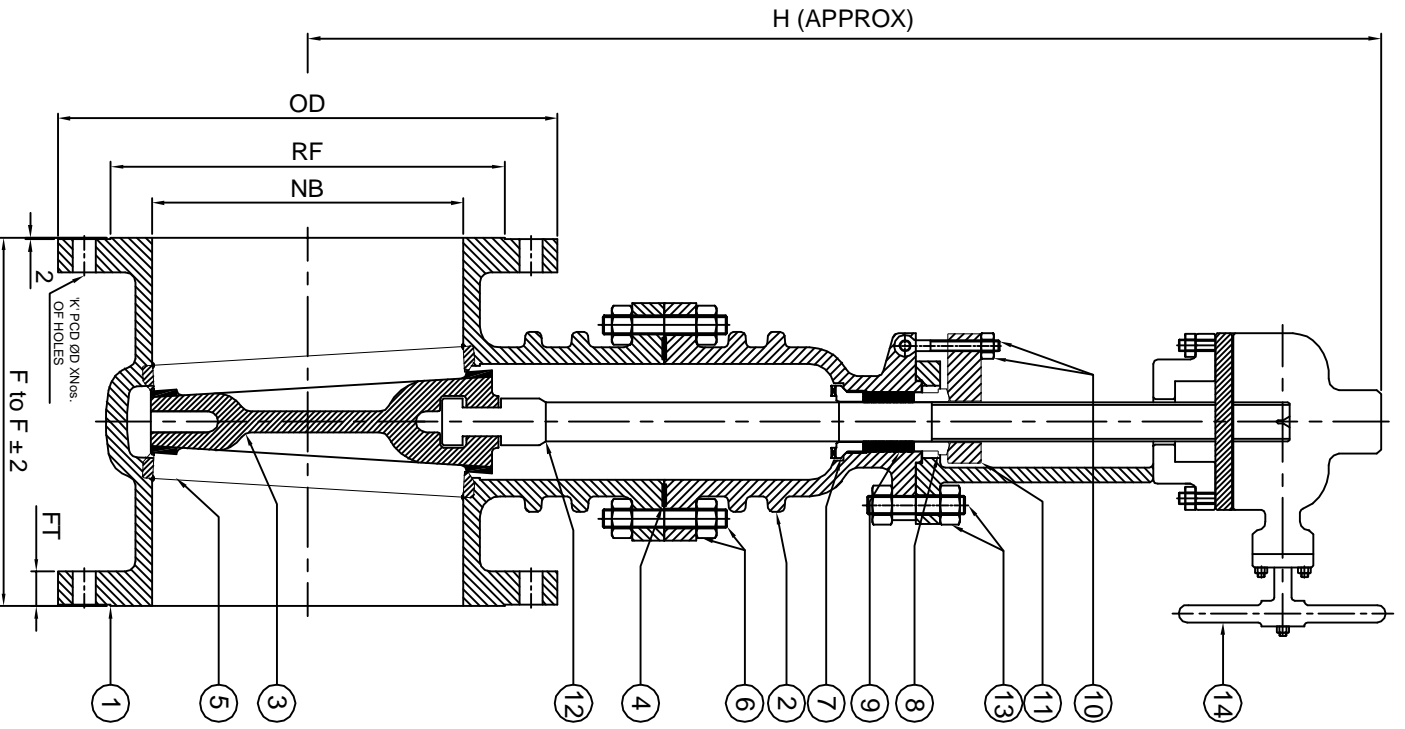

P.NO.	PART NAME	MATERIAL
1	BODY	ASTM A-216 Gr. WCB
2	BONNET	ASTM A - 216 Gr. WCB
3	WEDGE	A 216 WCB with 13% Cr. STEEL FACING
4	BONNET GASKET	SS 304 SPIRAL WOUND GASKET WITH GRAPHIOL FILLER
5	SEAT	A 105 + 13% Cr. FACING
6	STUD / NUT	ASTM A 193 Gr. B7/A 194 Gr.2H
7	BACK SEAT	AISI 410
8	GLAND	AISI 410
9	GLAND PACKING	GRAPHITED LUBRICATED NON-ASBESTOS IMPREGNATED WITH SACRIFICIAL INCONEL WIRE
10	GLAND BOLTING	ASTM A 193 Gr. B7/A 194 Gr.2H
11	GLAND FLANGE	CARBON STEEL
12	STEM	AISI 410
13	YOKE BOLTING	ASTM A 193 Gr. B7/A 194 Gr.2H
14	GEAR BOX	HEAVY DUTY STANDARD MAKE

NOTE :-

MATERIAL GIVEN IN TABLE IS FOR REFERENCE ONLY.
OTHER MATERIALS LIKE CARBON STEEL, LOW CARBON STEEL, ALLOY STEEL, STAINLESS STEEL, DUPLEX STEEL, SUPER DUPLEX STEEL, ALLOY 20, MONEL, INCONEL, HASTELLOY, COPPER ALLOY AVAILABLE AS PER SERVICE REQUIREMENT.

Size(NB)	F to F	OD	FT	K' PCD	Hole X ØD	RF	H
300mm	356	485	31.75	431.8	12 X 25.4	381	1035
350mm	381	535	35.05	476.3	12 X 28.4	412.8	1275
400mm	406	595	36.5	539.8	16 X 28.4	469.9	1455
450mm	432	635	39.6	577.9	16 X 31.7	533.4	1609
500mm	457	700	42.9	635	20 X 31.7	584.2	1814
600mm	508	815	47.7	749.3	20 X 35	692.1	2175

ENGINEERING DATA	
DESIGN CODE	API. 600 / ASME B 16.34
FACE TO FACE	ASME B 16.10
END CONNECTION	ASME B 16.5 RF TO 125-250 AARRH
INSPECTION & TESTING	API. 598

HYDRO TEST: 150#	SEAT	BACK SEAT	AIR TEST SEAT
BODY	22 KG/CM ²	22 KG/CM ²	07 KG/CM ²
32 KG/CM ²			

DRN. : B.M.P	
CHK. : V.G.P	
APRD. : S.K.P	
DATE: 01.04.19	GATE VALVE FLANGED ENDS, 150#.
SCALE: NTS	