



PRESSURE BRAND CAST IRON GLOBE VALVE FLANGED

PRODUCT DESCRIPTION

- **Product** : 'PRESSURE' Cast Iron Globe Valve
- **Product Standard** : BS:5152 / DIN 86251
- **Type of Pattern** : Straight Pattern
- **Pressure / Class / Rating** : PN 16
- **Body Material cum Standard** : Cast Iron
- **Description** : Bolted Bonnet, Outside Screw & Yoke Type Rising Stem
- **Type of Seat** : Renewable seat
- **Type of Disc** : Renewable disc Trim : SS AISI-410
- **Gland Packing** : Expanded Pure Flexible Graphite
- **End Details** : Flanges as per DIN 2533 RF (PN 16) drilled

HSN 84818030

APPLICATION

Water Steam

TESTING & CERTIFICATION

- **Rating** : PN 16
- **Body Test Pressure** : 24Kg/cm²g (Hyd.)
- **Seat Test Pressure** : 16Kg/cm²g (Hyd.)
- **Backseat Pressure** : 16Kg/cm²g (Hyd.)
- **Working Pressure** : Max BOP 13Kg/cm²g at 220°C Steam
- Test Certificate furnished with every supply.

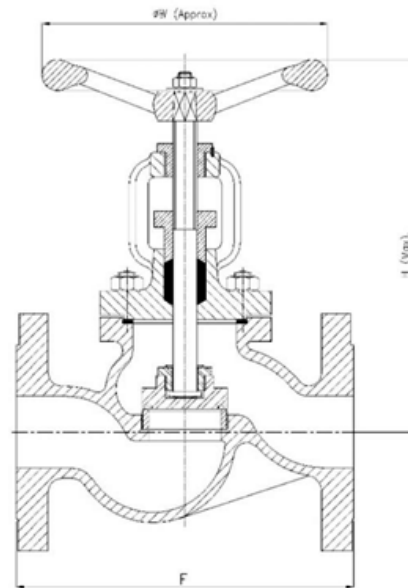

Reg. Office :9, Amar Asha Society, Nr. Ramvadi Bus Stop, Isanpur, Ahmedabad-382443. Gujarat, India. **Ph.** : +91 7490034801, 9824334801

Factory & Correspondence Address : 16, Ambica Industrial Estate, Nr. Vatva Railway Over Bridge, Vatva, Ahmedabad-382440, Gujarat, India.

Ph. : +91 8320479614, 6354226326 **E-mail** : info@pressurevalves.in, marketing@pressurevalves.in **Web** : www.pressurevalves.in



PRESSURE BRAND CAST IRON GLOBE VALVE FLANGED

MATERIALS OF CONSTRUCTION

Components	Materials	Specifications
Body, Bonnet, Valve Disc, Gland & Handwheel	Cast Iron	CI
Body Seat Ring, Valve Disc Ring, Spindle & Check Nut	Stainless Steel	AISI-410
Gasket	Compressed Asbestos	IS:2712 Gr.C
Gland Packing	Expanded Pure Flexible Graphite	—
Fasteners	Mild Steel	—
Yoke Bush	Aluminum Bronze	—

DIMENSIONS (IN MM)

Nominal Size	Nominal Size (Inches)	F	H (Open)	W (Approx.)
15	1/2	130±1	180	125
20	3/4	150±1	190	125
25	1	160±1	200	125
32	1.1/4	180±1	225	125
40	1.1/2	200±1	250	160
50	2	230±2	260	160
65	2.1/2	290±2	315	200
80	3	310±2	350	200
100	4	350±2	410	250
125	5	400±3	455	250
150	6	480±3	530	315
200	8	600±3	600	400

Notes : 1. Product images are for illustration purposes only. Actual product may vary.

2. Actual dimensions may change over time, due to continual design improvements. Please confirm before placing order.

Reg. Office : 9, Amar Asha Society, Nr. Ramvadi Bus Stop, Isanpur, Ahmedabad-382443. Gujarat, India. **Ph. :** +91 7490034801, 9824334801

Factory & Correspondence Address : 16, Ambica Industrial Estate, Nr. Vatva Railway Over Bridge, Vatva, Ahmedabad-382440, Gujarat, India.

Ph. : +91 8320479614, 6354226326 **E-mail :** info@pressurevalves.in, marketing@pressurevalves.in **Web :** www.pressurevalves.in

Approved by
 **NSIC**



 **IBR**
Approved

MANUFACTURER OF INDUSTRIAL VALVES AND GEARS



PRESSURE BRAND CAST STEEL GLOBE VALVE ND 40

PRODUCT DESCRIPTION

- **Product** : 'PRESSURE' Cast Steel Globe Valve
- **Product Standard** : BS 5160
- **Pressure / Class / Rating** : PN 40
- **Body Material cum Standard** : CCS (ASTM A216 Gr.WCB)
- **Description** : Bolted Bonnet, OS & Yoke Type, Rising Stem
- **Type of Seat** : Renewable seat
- **Type of Disc** : Renewable disc
- **Trim** : SS AISI-410
- **Gland Packing** : Expanded Pure Flexible Graphite
- **Ends** : Flanges as per BS 4504 Part-1 / DIN 2545 RF c

TESTING & CERTIFICATION

- **Body Test Pressure** : 76 Bar g (1100 Psig) Hyd.
- **Seat & Back Seat Test Pressure** : 40 Bar g (580 Psig) Hyd. Maximum
- **Working Temperature** : 400°C
- Test Certificate furnished with every supply.

HSN 84818030

APPLICATION

Water	Oil	Steam
-------	-----	-------

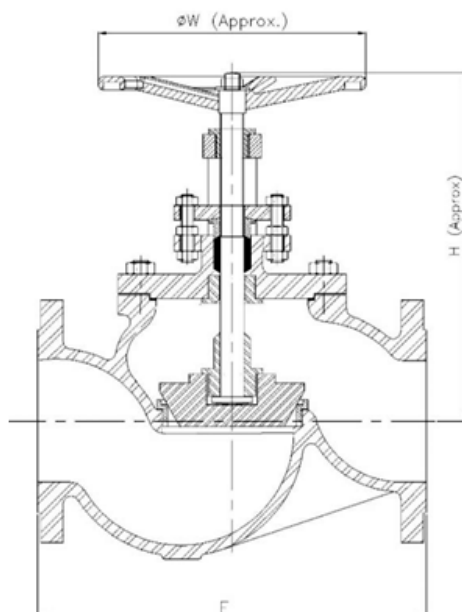

Reg. Office : 9, Amar Asha Society, Nr. Ramvadi Bus Stop, Isanpur, Ahmedabad-382443. Gujarat, India. **Ph.** : +91 7490034801, 9824334801

Factory & Correspondence Address : 16, Ambica Industrial Estate, Nr. Vatva Railway Over Bridge, Vatva, Ahmedabad-382440, Gujarat, India.

Ph. : +91 8320479614, 6354226326 **E-mail** : info@pressurevalves.in, marketing@pressurevalves.in **Web** : www.pressurevalves.in

Approved by



MANUFACTURER OF INDUSTRIAL VALVES AND GEARS



PRESSURE BRAND CAST STEEL GLOBE VALVE FLANGED, CLASS-150 (IBR APPROVED)

PRODUCT DESCRIPTION

- **Product** : 'PRESSURE' Cast Steel Globe Valve
- **Product Standard** : BS 1873
- **Pressure / Class / Rating** : Class 150
- **Body Material cum Standard** : CCS (ASTM A216 Gr.WCB)
- **Description** : Bolted Cover, Outside Screw & Yoke Type, Rising Stem
- **Type of Seat** : Renewable seat
- **Type of Disc** : Renewable disc Trim : Stem SS AISI-410
- **Yoke Bush** : Aluminum Bronze
- **Gland Packing** : Expanded Pure Flexible Graphite
- **End Details** : Flanges as per ANSI B 16.5 Class 150 R.F. drilled

TESTING & CERTIFICATION

- **Body Test Pressure** : 32 Bar g (435 Psig) Hyd.
- **Seat Test Pressure** : 22 Bar g (320 Psig) Hyd. & 6.9 Bar g (100 Psig) Air
- **Tested as per** API 598 / ANSI B16.34 / BS : 6755 Part 1
- **Maximum Working Temperature**: 400°C

Test Certificate in Form III-C as per IBR is furnished with every supply.

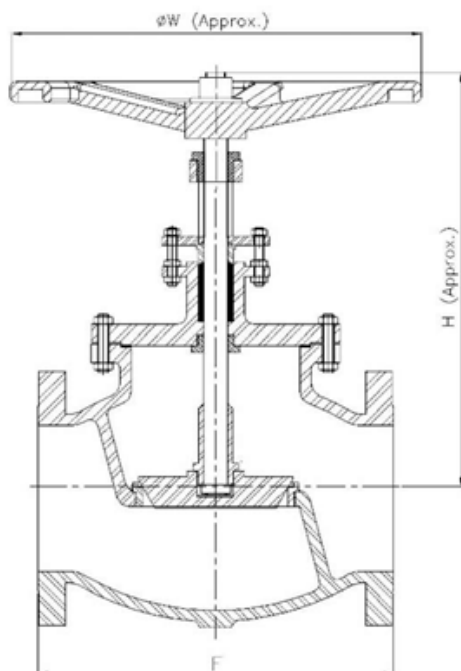

HSN 84818030

APPLICATION

Water	Oil	Steam
-------	-----	-------



Reg. Office :9, Amar Asha Society, Nr. Ramvadi Bus Stop, Isanpur, Ahmedabad-382443. Gujarat, India. **Ph.** : +91 7490034801, 9824334801

Factory & Correspondence Address : 16, Ambica Industrial Estate, Nr. Vatva Railway Over Bridge, Vatva, Ahmedabad-382440, Gujarat, India.

Ph. : +91 8320479614, 6354226326 **E-mail** : info@pressurevalves.in, marketing@pressurevalves.in **Web** : www.pressurevalves.in

Approved by



MANUFACTURER OF INDUSTRIAL VALVES AND GEARS



PRESSURE BRAND CAST STEEL GLOBE VALVE FLANGED, CLASS-150 (IBR APPROVED)

MATERIALS OF CONSTRUCTION

Components	Materials	Specifications
Body, Bonnet, Gland Flange	Cast Carbon Steel	ASTM A216 Gr.WCB
Gasket	CAF	BS:1832
Gland Packing	Expanded Pure Flexible Graphite	—
Handwheel	Malleable Iron / C.I.	IS:14329
Body Rings, Gland Follower, Stem, Locking Screws	Stainless Steel	AISI-410
Gland Bolting	Carbon Steel	UTS 392 N/mm ²
Bolts	Alloy Steel	ASTM A193 Gr.B7
Nuts	HT Steel	ASTM A194 Gr.2H
Yoke Bush	Al Bronze	—

DIMENSIONS (IN MM)

Nominal Size	Nominal Size (Inches)	F	H (Approx.)	W	D	T	R
25	1	127	255	125	110	11.6	50.8
32	1.1/4	140	265	125	115	13.2	63.5
40	1.1/2	165	270	160	125	14.7	73
50	2	203	290	160	150	16.3	92.1
65	2.1/2	211	355	200	180	17.9	104.8
80	3	241	380	200	190	19.5	127
100	4	292	420	250	230	24.3	157.2
150	6	406	515	315	280	25.9	215.9
200	8	495	610	400	345	29	269.9
250	10	622	620	450	405	30.6	323.9
300	12	698	720	500	485	32.2	381

Notes : 1. Product images are for illustration purposes only. Actual product may vary.

2. Actual dimensions may change over time, due to continual design improvements. Please confirm before placing order.

Reg. Office : 9, Amar Asha Society, Nr. Ramvadi Bus Stop, Isanpur, Ahmedabad-382443. Gujarat, India. **Ph. :** +91 7490034801, 9824334801

Factory & Correspondence Address : 16, Ambica Industrial Estate, Nr. Vatva Railway Over Bridge, Vatva, Ahmedabad-382440, Gujarat, India.

Ph. : +91 8320479614, 6354226326 **E-mail :** info@pressurevalves.in, marketing@pressurevalves.in **Web :** www.pressurevalves.in

Approved by





Approved

MANUFACTURER OF INDUSTRIAL VALVES AND GEARS



PRESSURE BRAND CAST STEEL GLOBE VALVE FLANGED, CLASS-300 (IBR APPROVED)

PRODUCT DESCRIPTION

- **Product** : 'PRESSURE' Cast Steel Globe Valve
- **Product Standard** : BS 1873
- **Pressure / Class / Rating** : Class-300
- **Body Material cum Standard** : CCS (ASTM A216 Gr.WCB)
- **Description** : Bolted Cover, Outside Screw & Yoke Type, Risir
- **Type of Seat** : Renewable seat
- **Type of Disc** : Renewable disc
- **Trim** : Stem SS AISI-410
- **Yoke Bush** : Aluminum Bronze
- **Gland Packing** : Expanded Pure Flexible Graphite
- **End Details** : Flanges as per ANSI B 16.5 Class 300 R.F. drilled

HSN 84818030

APPLICATION

Water	Oil	Steam
-------	-----	-------

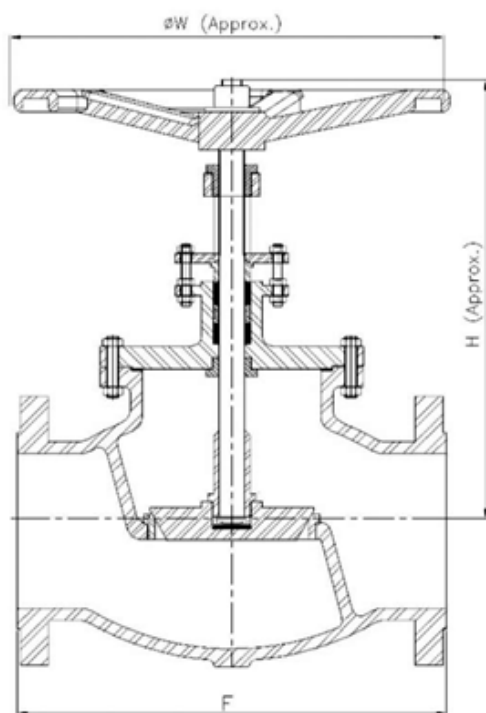

TESTING & CERTIFICATION

- **Body Test Pressure** : 80 Bar g (1102 Psig) Hyd.
- **Seat Test Pressure** : 58 Bar g (815 Psig) Hyd. & 6.9 Bar g (100 Psig) Air
- **Tested as per** API 598 / ANSI B16.34 / BS : 6755 Part 1
- **Maximum Working Temperature**: 425°C
- Test Certificate in Form III-C as per IBR is furnished with every supply.

Reg. Office : 9, Amar Asha Society, Nr. Ramvadi Bus Stop, Isanpur, Ahmedabad-382443. Gujarat, India. **Ph.** : +91 7490034801, 9824334801

Factory & Correspondence Address : 16, Ambica Industrial Estate, Nr. Vatva Railway Over Bridge, Vatva, Ahmedabad-382440, Gujarat, India.

Ph. : +91 8320479614, 6354226326 **E-mail** : info@pressurevalves.in, marketing@pressurevalves.in **Web** : www.pressurevalves.in

Approved by



MANUFACTURER OF INDUSTRIAL VALVES AND GEARS



PRESSURE BRAND CAST STEEL GLOBE VALVE FLANGED, CLASS-600

PRODUCT DESCRIPTION

- **Product** : PRESSURE Cast Steel Globe Valve
- **Product Standard** : BS 1873
- **Pressure / Class Rating** : Class 600
- **Body Material cum standard** : CCS (ASTM A-216 Gr. WCB)
- **Product Description** : Bolted Bonnet O/S Yoke Type Rising Stem
- **Type of Seat** : Renewable
- **Type of Disc** : Renewable Disc
- **Trim** : SS AISI-410
- **End Details** : Flanges as per ASME B 16.5 Class 600 RF drilled

HSN 84818030



TESTING & CERTIFICATION

- **Body Test Pressure** : 153 Barg (2220 Psig.) Hyd.
- **Seat Test Pressure** : 112 Barg (1630 Psig.) Hyd. 6.9barg 100 Psig. (AIR)
- Our Works' Test Certificate is furnished with every supply.

SIZES / DIMENSIONS

Nominal Size	Nominal Size (Inches)	F	H (Approx)	W(Approx)
40	1.1/2	242	305	200
50	2	292	360	254
65	2.1/2	330	405	305
80	3	356	450	305
100	4	432	525	450
150	6	559	670	560
200	8	660	740	600

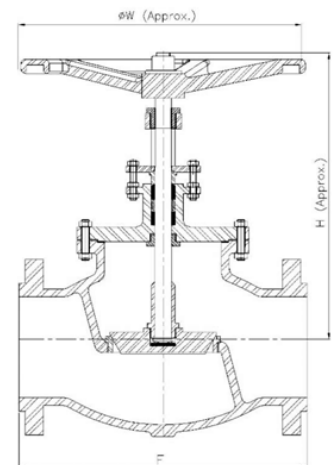

MATERIALS OF CONSTRUCTION

Components	Materials	Specifications
Body, Bonnet, Disc, Gland Flange	C.C.S.	ASTM A216 Gr. WCB
Stem, Back Seat Bush, Body Seat Ring, Valve Disc Ring, Gland Follower, Lantern Ring & Thrust Plate	Stainless Steel	AISI-410
Gasket	Spiral Wound S.S. 304 with Graphite Filler	—
Gland Packing	Expanded Pure Flexible Graphite	—
Fasteners	Mild Steel	—
Yoke Bush	Aluminum Bronze	—
Handwheel	M.I./D.I	—

- Notes** : 1. Product images are for illustration purposes only. Actual product may vary.
2. Actual dimensions may change over time, due to continual design improvements. Please confirm before placing order

Reg. Office : 9, Amar Asha Society, Nr. Ramvadi Bus Stop, Isanpur, Ahmedabad-382443. Gujarat, India. **Ph.** : +91 7490034801, 9824334801
Factory & Correspondence Address : 16, Ambica Industrial Estate, Nr. Vatva Railway Over Bridge, Vatva, Ahmedabad-382440, Gujarat, India.
Ph. : +91 8320479614, 6354226326 **E-mail** : info@pressurevalves.in, marketing@pressurevalves.in **Web** : www.pressurevalves.in