



PRESSURE BRAND BRASS SWING CHECK VALVE SCREWED

PRODUCT DESCRIPTION

- **Product** : PRESSURE Brass Swing Check Valve
- **Body Material** : Brass
- **Type of Disc** : Brass
- **End Details** : Screwed ends with BSP Parallel Threads

HSN 84818090

TESTING & CERTIFICATION

- **Body Test Pressure** : 20kg/cm²g (Hyd.)
- **Working Pressure** : 13.5kg/cm²g (Hyd.)

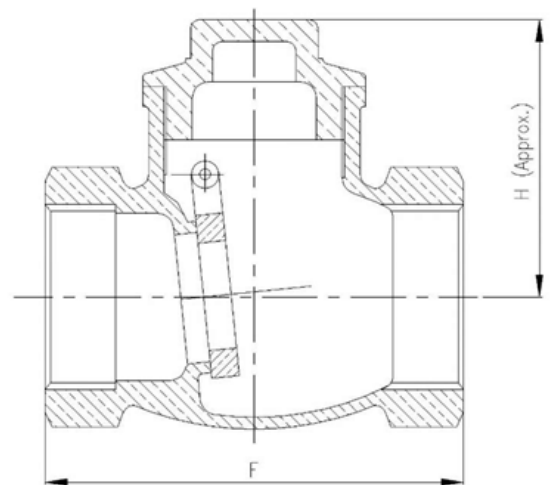

DIMENSIONS (IN MM)

Size	F	H
15	47	33
20	55	34
25	61	43

MATERIALS OF CONSTRUCTION

Components	Materials	Specifications
Cover	Brass	—
Body	Brass	—
Hinge Pin	Brass	—
Disc	Brass	—

Notes : 1. Product images are for illustration purposes only. Actual product may vary.

2. Actual dimensions may change over time, due to continual design improvements. Please confirm before placing order.

Reg. Office : 9, Amar Asha Society, Nr. Ramvadi Bus Stop, Isanpur, Ahmedabad-382443. Gujarat, India. **Ph.** : +91 7490034801, 9824334801

Factory & Correspondence Address : 16, Ambica Industrial Estate, Nr. Vatva Railway Over Bridge, Vatva, Ahmedabad-382440, Gujarat, India.

Ph. : +91 8320479614, 6354226326 **E-mail** : info@pressurevalves.in, marketing@pressurevalves.in **Web** : www.pressurevalves.in



PRESSURE BRAND BRONZE HORIZONTAL LIFT CHECK VALVE HEAVY, SCREWED

PRODUCT DESCRIPTION

- **Product** : 'PRESSURE' Bronze Horizontal Lift Check Valve
- **Type of Pattern** : Heavy Pattern
- **Body Material cum Standard** : GM (IS:318 Gr.LTB2)
- **Description** : Screwed in Cover
- **Type of Seat** : Integral seat
- **Type of Disc** : Renewable disc Trim : Cu-Alloy
- **End Details** : Screwed Female BSP threads to BS 21.

HSN 84813000

APPLICATION

Water	Oil
-------	-----

TESTING & CERTIFICATION

- **Body Test Pressure** : 35.15Kg/cm²g (500Psig. Hyd.)
- **Seat Test Pressure** : 21.09Kg/cm²g (300Psig. Hyd.)
- Our Works' Test Certificate is furnished with every supply.

SIZES / DIMENSIONS

Nominal Size	Nominal Size (Inches)	F	H
8	1/4	47	30
10	3/8	51	30
15	1/2	54	38
20	3/4	65	43
25	1	80	55
32	1.1/4	90	55
40	1.1/2	102	60
50	2	122	75
65	2.1/2	147	90
80	3	170	105
100	4	200	120



MATERIALS OF CONSTRUCTION

Components	Materials	Specifications
Body, Cover & Valve Disc	Leaded Tin Bronze	IS:318 Gr.LTB2

- Notes** : 1. Product images are for illustration purposes only. Actual product may vary.
2. Actual dimensions may change over time, due to continual design improvements. Please confirm before placing order

Reg. Office : 9, Amar Asha Society, Nr. Ramvadi Bus Stop, Isanpur, Ahmedabad-382443. Gujarat, India. **Ph.** : +91 7490034801, 9824334801
Factory & Correspondence Address : 16, Ambica Industrial Estate, Nr. Vatva Railway Over Bridge, Vatva, Ahmedabad-382440, Gujarat, India.
Ph. : +91 8320479614, 6354226326 **E-mail** : info@pressurevalves.in, marketing@pressurevalves.in **Web** : www.pressurevalves.in



PRESSURE BRAND BRONZE VERTICAL LIFT CHECK VALVE SCREWED

PRODUCT DESCRIPTION

- **Product** : 'PRESSURE' Bronze Vertical Lift Check Valve
- **Type of Pattern** : Standard Pattern
- **Body Material cum Standard** : GM (IS:318 Gr.LTB2)
- **Type of Seat** : Integral seat
- **Type of Disc** : Renewable disc
- **Trim** : Cu-Alloy
- **End Details** : Screwed Female BSP threads to BS 21.

TESTING & CERTIFICATION

- **Body Test Pressure** : 21.09Kg/cm²g (300Psig. Hyd.)
- **Seat Test Pressure** : 14.06Kg/cm²g (200Psig. Hyd.)
- Our Works' Test Certificate is furnished with every supply.

DIMENSIONS (IN MM)

Nominal Size	Nominal Size (Inches)	F
15	1/2	55
20	3/4	65
25	1	70
32	1.1/4	80
40	1.1/2	85
50	2	95
65	2.1/2	130
80	3	145
100	4	190

MATERIALS OF CONSTRUCTION

Components	Materials	Specifications
Body & Valve Disc	Leaded Tin Bronze	IS:318 Gr.LTB2
Nut & Washer	Forged Brass	—
Spring	Phosphor Bronze	—

- Notes** : 1. Product images are for illustration purposes only. Actual product may vary.
2. Actual dimensions may change over time, due to continual design improvements. Please confirm before placing order

HSN 84813000

APPLICATION

Water Oil



Reg. Office : 9, Amar Asha Society, Nr. Ramvadi Bus Stop, Isanpur, Ahmedabad-382443. Gujarat, India. **Ph.** : +91 7490034801, 9824334801
Factory & Correspondence Address : 16, Ambica Industrial Estate, Nr. Vatva Railway Over Bridge, Vatva, Ahmedabad-382440, Gujarat, India.
Ph. : +91 8320479614, 6354226326 **E-mail** : info@pressurevalves.in, marketing@pressurevalves.in **Web** : www.pressurevalves.in

Approved by
NSIC
एन एस आई सी



IBR
Approved

MANUFACTURER OF INDUSTRIAL VALVES AND GEARS