



PRESSURE BRAND FORGED BRASS BALL VALVE (SCREWED)

SALIENT FEATURES

- Product : Pressure Forged Brass Ball Valve
- Pressure Rating : PN-25
- Body Material cum Standard Forged Brass
- Product Description : Two Piece Design Lever Operated
- Type of Seat Renewal PTFE Seat
- Type of Ball Brass Nickel Plated
Stem Machined Brass Nickel Plated
Packing PTFE
Port Opening Full Bore
- End Details : Screwed Female BSP Parallel Threads
Crome Finish

SUITABLE FOR

Water, Oil



- Test Pressure (Hydrostatic) :
- Body Test Pressure Shell 40 kg/cm²
- Working Pressure : 25kg/cm²

MATERIALS

P.No.	Name of Part	Material of Construction	Specification	Quantity
1	Body	Forged Brass	IS 6912 Gr. FLB	1
2	Connector	Forged Brass	IS 6912 Gr. FLB	1
3	Ball	Forged Brass (Hard Chrome Plated)	IS 6912 Gr. FLB	1
4	Body Seat Ring	PTFE	BS EN 12086 – 1	2
5	Thrust Washer	PTFE	BS EN 12086 – 1	1
6	Gland Packing	PTFE	BS EN 12086 – 1	–
7	Stem	Forged Brass	IS 6912 Gr. FLB	1
8	Gland	Forged Brass	---	1
9	Lever	Aluminium Alloy / Mild Steel	---	1
10	Nut	Brass (Chrome Plated)	---	1

SIZES / DIMENSIONS

Size (Inches)	Size (mm)	A ±1.5	B	C ~	D ~
1/4	8	40	1/4"	37	90
3/8	10	45	3/8"	37	90
1/2	15	50	1/2"	40	106
3/4	20	56	3/4"	43	132
1	25	66	1"	51	132
1 1/4	32	75	1 1/4"	65	166
1 1/2	40	88	1 1/2"	72	176
2	50	105	2"	80	216
2 1/2	65	124	2 1/2"	102	216
3	80	148	3"	110	280
4	100	212	4"	124	280

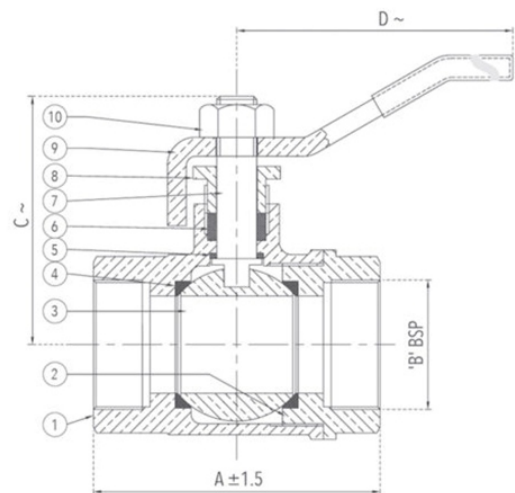

Notes : 1. Product images are for illustration purposes only. Actual product may vary.

2. Actual dimensions may change over time, due to continual design improvements. Please confirm before placing order.

Reg. Office : 9, Amar Asha Society, Nr. Ramvadi Bus Stop, Isanpur, Ahmedabad-382443. Gujarat, India. **Ph. :** +91 7490034801, 9824334801

Factory & Correspondence Address : 16, Ambica Industrial Estate, Nr. Vatva Railway Over Bridge, Vatva, Ahmedabad-382440, Gujarat, India.

Ph. : +91 8320479614, 6354226326 **E-mail :** info@pressurevalves.in, marketing@pressurevalves.in **Web :** www.pressurevalves.in



PRESSURE BRAND CAST IRON BALL VALVE CLASS 125, SCREWED

PRODUCT DESCRIPTION

- **Product** : 'PRESSURE' Cast Iron Ball Valve
- **Product Standard** : IS:9890 Class 125
- **Type of Pattern** : Straight
- **Body Material cum Standard** : Cast Iron IS:210 Gr.FG220
- **Description** : Two piece design
- **Type of Seat** : Renewable Teflon
- **Trim : Stem**: SS AISI-410, **Ball**: SS AISI-304
- **Gland Packing** : Teflon Rings
- **End Details** : Screwed female Parallel threads as per IS:554

HSN 84818030

APPLICATION

Water	Oil	Gas
-------	-----	-----

NOTE : Cover will be screwed in type for 50mm valve size & below

TESTING & CERTIFICATION

- **Body Test Pressure** : 300 Psig. Hyd.
- **Seat Test Pressure** : 220 Psig. Hyd., 100 Psig. Air
- Our Works' Test Certificate is furnished with every supply.

DIMENSIONS (IN MM)

Nominal Size	Nominal Size (Inches)	F	LL (Approx.)
15	1/2	72±2	135
20	3/4	87±2	135
25	1	100±2	160
32	1.1/4	121±2	160
40	1.1/2	121±2	220
50	2	135±2	220
65	2.1/2	151±2	250
80	3	172±2	260
100	4	217±2	325



MATERIALS OF CONSTRUCTION

Components	Materials	Specifications
Body	Cast Iron	IS:210 Gr.FG220
Ball	Stainless Steel	AISI-304
Spindle	Stainless Steel	AISI-410
Body Seats & Gland Seals	Teflon	PTFE
Stopper, Gland Nut, Handle & Fasteners	Mild Steel	IS:2062:1992
Hand Sleeve	PVC	—

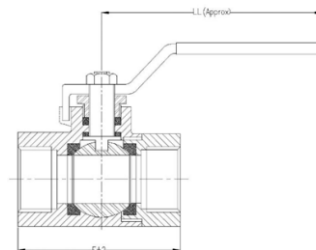

- Notes** : 1. Product images are for illustration purposes only. Actual product may vary.
2. Actual dimensions may change over time, due to continual design improvements. Please confirm before placing order.

Reg. Office : 9, Amar Asha Society, Nr. Ramvadi Bus Stop, Isanpur, Ahmedabad-382443. Gujarat, India. **Ph.** : +91 7490034801, 9824334801
Factory & Correspondence Address : 16, Ambica Industrial Estate, Nr. Vatva Railway Over Bridge, Vatva, Ahmedabad-382440, Gujarat, India.
Ph. : +91 8320479614, 6354226326 **E-mail** : info@pressurevalves.in, marketing@pressurevalves.in **Web** : www.pressurevalves.in



PRESSURE BRAND STAINLESS STEEL BALL VALVE SCREWED

PRODUCT DESCRIPTION

HSN 84818090

- **Product** : PRESSURE Stainless Steel Ball Valve
- **Body Material Cum Standard** : Investment casting SS CF 8 M/CF 8
- **Product Description** : Two Piece Design Lever Operated
- **Type of Seat** : Renewable PTFE Seat
- **Type of Ball** : CF-8 SS 304/CF 8 M SS 316
- **Stem** : SS 304/ SS 316
- **Packing** : PTFE
- **End Details** : Screwed Female BSP Taper Threads
- **Port Opening** : Full Bore



TESTING & CERTIFICATION

- **Body Test Pressure** : 60kg/cm²g Hyd.
- **Seat Test Pressure** : 40kg/cm²g Hyd.
- Our Works' Test Certificate is furnished with every supply.

DIMENSIONS (IN MM)

Nominal Size	Nominal Size (Inches)	F	LL (Approx.)
15	1/2	58±2	104
20	3/4	66±2	109
25	1	79±2	125
32	1.1/4	90±2	139
40	1.1/2	105±2	153
50	2	118±2	158

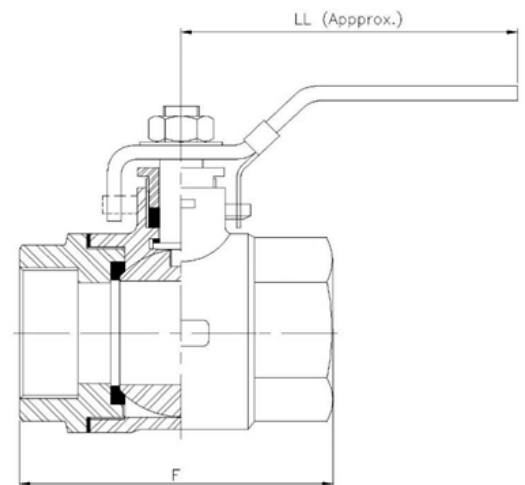

MATERIALS OF CONSTRUCTION

Components	Materials	Specifications
Body, Ball	S.S.	ASTM A 351 GR.CF 8/CF 8 M
Stem	S.S.	AISI 304/AISI-316
Gasket, Gland packing, Thrust Washer, Seat	PTFE	—
Connector	C.C.S.	AISI 304 /CF 8/ AISI-316/CF8-M
Gland Nut, Nut	S.S.	AISI 304/AISI-316
Lever	S.S.	AISI-201 With PVC Sleeve

- Notes** : 1. Product images are for illustration purposes only. Actual product may vary.
2. Actual dimensions may change over time, due to continual design improvements. Please confirm before placing order.

Reg. Office : 9, Amar Asha Society, Nr. Ramvadi Bus Stop, Isanpur, Ahmedabad-382443. Gujarat, India. **Ph.** : +91 7490034801, 9824334801
Factory & Correspondence Address : 16, Ambica Industrial Estate, Nr. Vatva Railway Over Bridge, Vatva, Ahmedabad-382440, Gujarat, India.
Ph. : +91 8320479614, 6354226326 **E-mail** : info@pressurevalves.in, marketing@pressurevalves.in **Web** : www.pressurevalves.in



PRESSURE BRAND CAST IRON BALL VALVE CLASS 125, FLANGED

PRODUCT DESCRIPTION

- **Product** : 'PRESSURE' Cast Iron Ball Valve
- **Product Standard** : IS:9890 Class 125
- **Body Material cum Standard** : Cast Iron IS:210 Gr.FG220
- **Description** : Three piece design
- **Type of Seat** : Renewable Teflon
- **Trim : Stem**: SS AISI-410 Stainless Steel, Ball: SS AISI-304/AISI-316
- **Gland Packing** : Teflon Rings
- **End Details** : Flanges as per IS:3516-1966 drilled/B.S.10 Table F

TESTING & CERTIFICATION

- **Body Test Pressure** : 300 Psig. (21 bar g) Hyd.
- **Seat Test Pressure** : 220 Psig. (15.4 bar g) Hyd., 100 Psig. (6.9 bar g) Air
- Our Works' Test Certificate is furnished with every supply.

DIMENSIONS (IN MM)

Nominal Size	Nominal Size (Inches)	F	LL (Approx.)
15	1/2	130±2	135
20	3/4	130±2	160
25	1	140±2	170
32	1 1/4	165±2	210
40	1 1/2	164±2	210
50	2	203±2	210
65	2 1/2	222±2	250
80	3	241±2	260
100	4	305±2	360

HSN 84818030

APPLICATION

Water	Oil	Gas
-------	-----	-----

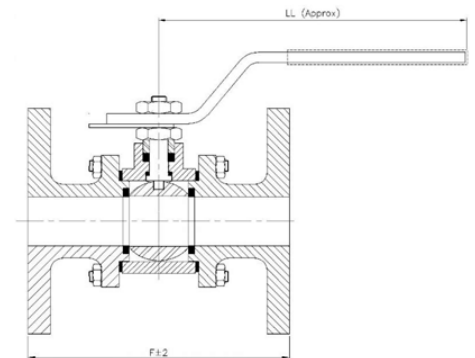

MATERIALS OF CONSTRUCTION

Components	Materials	Specifications
Body	Cast Iron	IS:210 Gr.FG220
Ball	Stainless Steel	AISI-304/AISI-316
Stem	Stainless Steel	AISI-410/SS 304/SS 316
Body Seats & Gland Seals	Teflon	—
Stopper, Gland Nut, Handle & Fasteners	Mild Steel	IS:2062:1992
Hand Sleeve	PVC	—
Gasket	Compressed Asbestos Fibre	—

Notes : 1.Product images are for illustration purposes only. Actual product may vary.

2. Actual dimensions may change over time, due to continual design improvements. Please confirm before placing order.

Reg. Office :9, Amar Asha Society, Nr. Ramvadi Bus Stop, Isanpur, Ahmedabad-382443. Gujarat, India. **Ph.** : +91 7490034801, 9824334801

Factory & Correspondence Address : 16, Ambica Industrial Estate, Nr. Vatva Railway Over Bridge, Vatva, Ahmedabad-382440, Gujarat, India.

Ph. : +91 8320479614, 6354226326 **E-mail** : info@pressurevalves.in, marketing@pressurevalves.in **Web** : www.pressurevalves.in



PRESSURE BRAND STAINLESS STEEL BALL VALVE 2 PC/3 PC DESIGNED FLANGED, CLASS-150

PRODUCT DESCRIPTION

- **Product** : PRESSURE Stainless Steel Ball Valve (F), SS (304)/SS 316
- **Pressure/Class/Rated** : Class-150
- **Body Material Cum Standard** : INVESTMENT CASTING S.S. AISI-304 (CF-8)/SS 316
- **Product Description** : 3 Pc Design Lever Operated
- **Type of Seat** : Renewable
- **Stem** : AISI-304(CF 8)/AISI-316(CF 8M)
- **Ball** : AISI-304 (CF-8)/AISI-316 (CF 8 M)
- **Seat Ring & Gland Packing** : PTFE
- **End Details** : Flanges as per B 16.5 Class-150 (Drilled)

TESTING & CERTIFICATION

- **Body Test Pressure** : 30 Barg (435psig. Hyd.)
- **Seat Test Pressure** : 22 barg (320psig. Hyd.)
- **Maximum Working Temp.** : 225°C
- Our Works' Test Certificate is furnished with every supply.

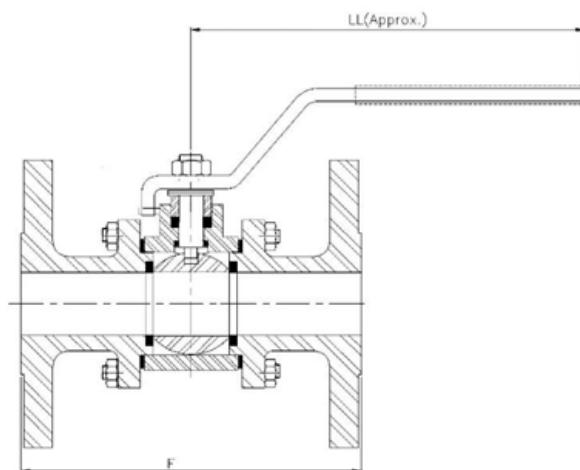

DIMENSIONS (IN MM)

Nominal Size	Nominal Size (Inches)	F
15	1/2	108±2
20	3/4	117±2
25	1	127±2
32	1.1/4	140±2
40	1.1/2	165±2
50	2	178±2
65	1/2	190±2
80	3/4	20±2
100	1	229±2



MATERIALS OF CONSTRUCTION

Components	Materials	Specifications
Body, Connector	C.S.S.	ASTMA 351-CF8/CF8 M
Ball, Stem, Gland, Spring Washer, Lever Nut, Fasteners	S.S.	AISI-304/316
Seat, Gland Packing	PTFE	—
Lever	S.S.	—

Notes : 1. Product images are for illustration purposes only. Actual product may vary.

2. Actual dimensions may change over time, due to continual design improvements. Please confirm before placing order.

Reg. Office : 9, Amar Asha Society, Nr. Ramvadi Bus Stop, Isanpur, Ahmedabad-382443. Gujarat, India. **Ph.** : +91 7490034801, 9824334801

Factory & Correspondence Address : 16, Ambica Industrial Estate, Nr. Vatva Railway Over Bridge, Vatva, Ahmedabad-382440, Gujarat, India.

Ph. : +91 8320479614, 6354226326 **E-mail** : info@pressurevalves.in, marketing@pressurevalves.in **Web** : www.pressurevalves.in



PRESSURE BRAND CAST STEEL BALL VALVE FLANGED

PRODUCT DESCRIPTION

- **Product** : 'PRESSURE' Cast Steel Ball Valve
- **Product Standard** : BS 5351 / API 6D
- **Type of Pattern** : Straight Type
- **Pressure / Class / Rating** : Class 150
- **Body Material cum Standard** : INVESTMENT CASTING CCS (ASTM A216 Gr.WCB)
- **Description** : Three Piece Design, Lever Operated
- **Type of Seat** : Renewable seat
- **Trim** : Stem S.S. ASTM A276 Type 410/T 304/T 316
- **Ball** : SS (ASTM A351 Gr. CF8 /CF 8 M (AISI-304/ AISI 316)
Seat Ring & Gland Packing PTFE
- **End Details** : Flanges as per ANSI B 16.5 Class 150 R.F.drilled

HSN 84818030

APPLICATION

Water	Oil	Gas	Steam
-------	-----	-----	-------



TESTING & CERTIFICATION

- **Body Test Pressure** : 30 Bar g (435 Psig) Hyd.
- **Seat Test Pressure** : 22 Bar g (320 Psig) Hyd. & 6.9 Bar g (100 Psig) Air
- **Maximum Working Temperature** : 250°C
- Test Certificate is furnished with every supply.

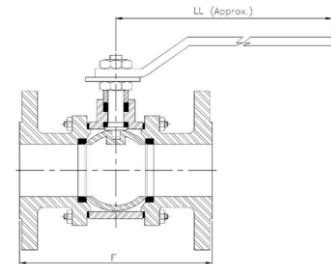

DIMENSIONS (IN MM)

Nominal Size	Nominal Size (Inches)	F	H Approx	LL Approx	QD	T	QR
25	1	127±2	80	165	110	11.6	50.8
32	1.1/4	140±2	95	205	115	13.2	63.5
40	1.1/2	165±2	100	220	125	14.7	73
50	2	178±2	106	220	150	16.3	92.1
65	2.1/2	191±2	145	350	180	17.9	104.8
80	3	203±2	155	400	190	19.5	127
100	4	229±2	175	450	230	24.3	157.2

MATERIALS OF CONSTRUCTION

Components	Materials	Specifications
Lever	Steel	with PVC Sleeve
Stem, Nut, Gland	13% Cr. S.S/SS 304/SS 316	AISI-304/AISI-316/AISI-410
Stopper	Steel	—
Packing Ring, Seat	PTFE / RPTFE	—
Studs & Nuts	Alloy Steel & H.T. Steel	ASTM A193 Gr.B7 & ASTM A194 Gr.2H
Ball	Stainless Steel	CF8/CF 8 M / AISI-304 / AISI-316
Body, Body Connector	C.S.	IC ASTM A216 Gr.WCB
Gasket	SPIRAL WOUND	SS304/SS 316

Notes : 1. Product images are for-illustration purposes only. Actual product may vary.

2. Actual dimensions may change over time, due to continual design improvements. Please confirm before placing order.

Reg. Office : 9, Amar Asha Society, Nr. Ramvadi Bus Stop, Isanpur, Ahmedabad-382443. Gujarat, India. **Ph.** : +91 7490034801, 9824334801

Factory & Correspondence Address : 16, Ambica Industrial Estate, Nr. Vatva Railway Over Bridge, Vatva, Ahmedabad-382440, Gujarat, India.

Ph. : +91 8320479614, 6354226326 **E-mail** : info@pressurevalves.in, marketing@pressurevalves.in **Web** : www.pressurevalves.in



PRESSURE BRAND WCB CAST STEEL BALL VALVE

PRODUCT DESCRIPTION

- **Product** : 'PRESSURE' Forged Carbon Steel Ball Valve
- **Pressure Temperature Rating** : 69 Barg at 30°C, 5 Bar at 225°C
- **Body Material cum Standard** : FCS (ASTM A 105)
- **Description** : Three piece design, Lever Operated
- **Type of Seat** : Renewable PTFE with Carbon Filled
- **Trim : Stem**: SS AISI-410, Ball: SS AISI-304/ CF8
- **Gland Packing** : PTFE
- **End Details** : Sockete Weld / Screwed female BSP Parallel



TESTING & CERTIFICATION

- **Body Test Pressure** : 104 Barg Hyd.
- **Seat Test Pressure** : 76 Barg Hyd.
- Our Works' Test Certificate is furnished with every supply.

DIMENSIONS (IN MM)

Nominal Size	Nominal Size (Inches)	F	LL (Approx.)
15	1/2	70±2	105
20	3/4	80±2	120
25	1	88±2	120
32	1.1/4	102±2	145
40	1.1/2	110±2	156
50	2	132±2	156

MATERIALS OF CONSTRUCTION

P. No.	Components	Materials	No.	Specifications
1	Body	1	F.C.S	ASTM A 105
2	Connector	2	F.C.S	ASTM A 105
3	Seat	2	Carbon Filled PTFE	—
4	Ball	1	SS	AISI-304
5	Stem	1	SS	AISI-410
6	Gland Seal	To Suit	Carbon Filled PTFE	—
7	Gland	1	SS	AISI-410
8	Lever	1	Carbon Steel	GALVANISED, PVC SLEEVE
9	Bolt & Nuts	To Suit	SS	—

Notes : 1. Product images are for illustration purposes only. Actual product may vary.

2. Actual dimensions may change over time, due to continual design improvements. Please confirm before placing order.

Reg. Office : 9, Amar Asha Society, Nr. Ramvadi Bus Stop, Isanpur, Ahmedabad-382443. Gujarat, India. **Ph.** : +91 7490034801, 9824334801

Factory & Correspondence Address : 16, Ambica Industrial Estate, Nr. Vatva Railway Over Bridge, Vatva, Ahmedabad-382440, Gujarat, India.

Ph. : +91 8320479614, 6354226326 **E-mail** : info@pressurevalves.in, marketing@pressurevalves.in **Web** : www.pressurevalves.in